

you can
Canon

DIGITAL NETWORK
PRODUCTION SYSTEM

iR105

Handle high quality,
production print jobs in record time.



OFFICIAL PARTNER

Handle high quality, production print jobs in record time



The Canon iR105 system brings unparalleled ease and efficiency to on-demand, black-and-white document management. Designed for short-run jobs and repeat printing, where deadlines are critical, it instantly delivers the print quantity and image quality required, offering a reduction in time and costs compared to offset printing.

The highly compact and reliable design features an iR controller with Image Platform architecture. A modular structure speeds up copying, printing, scanning and all network operations. With true multifunctional processing handling data at high speeds to achieve extremely efficient control of document input, editing and output.

No assistance is needed from a dedicated operator to complete jobs, as the system combines a powerful image server with a web-based remote user interface and a range of professional on-line finishing options, to provide complete control from all connected desktops. Offering the ideal solution for central reprographic departments, departmental document centres and also the print-for-pay market.

Superior speed and image quality

To achieve the highest levels of productivity, the iR105 features the world's highest scanning speed technology - inputting documents at 80 ipm and 600 dpi. Output is a rapid 105 ppm (A4) with consistently high image quality equivalent to 1200 x 600 dpi for copying and 2400 x 600 dpi for printing - with up to 256 gradations. While FCOT (First Copy Out Time) has been reduced to 3 seconds.

Continuous output

There's standard automatic trayless duplexing, with no drop in speed, to increase productivity. An innovative 'heat pipe' water cooling mechanism suppresses temperature increases during continuous operation and reduces density variations. Furthermore, printing between two iR105 systems, via a network, raises speed to a highly impressive 210 ppm.

Powerful, productive image server

The iR105 is equipped with a standard 10 GB integrated image server. This provides extensive possibilities for high performance document management and handling, making data exchange within a network easier and more efficient. It also enables copy reservation for up to 5 jobs - with no limit to the amount of images that can be scanned in continuously.

True document integration

Scanned documents and electronic files can be stored in a mailbox and password protected. Different file formats, such as Word documents and PowerPoint presentations, can be stored in the same box alongside scanned documents. They can then be merged, edited and printed out securely whenever required. Up to 100 mailboxes are available, with a maximum capacity of 2,000 documents containing up to 7,700 pages.

Compact ease, complete reliability

A rigid structure and compact, space-saving durable design makes the iR105 highly reliable. A large 20 cm colour LCD display with indicators for toner and staple supplies facilitates operation. Easy front operation allows toner and paper to be replenished during operation. Advanced paper transport technology reduces the risk of paper jams. Other advantages include a reliable A-Si drum and e-maintenance functionality.

Remote user interface (RUI)

A web-based remote user interface allows users to control operations directly from their workstations. This provides easy job administration, with advanced mailbox operation, priority settings and a time-saving status check. Finishing procedures can be freely set. There's full PostScript and PCL support - plus users can create their own printing profiles.

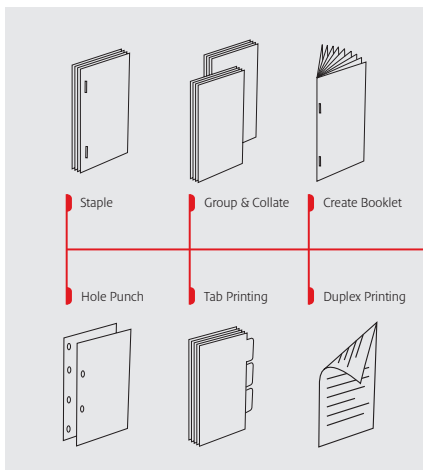

Full system with flexible finishing

Creative finishing options cover all needs. These include a Finisher for 100-sheet stapling and stacking, a Z-folding unit, a Saddle Finisher for professional production of A4 or A5 booklets - with automatic tab sheets insertion plus a tab sheet printing facility, or a 3000 sheet stacker. The Saddle Finisher comes in two versions, with 2 or 4-hole punching for filing purposes. A document insertion unit and trimmer unit are also available.

Complete production circle

Of course, these expert finishing options can be set directly from the desktop, via the RUI. The iR105 system also features a high capacity paper supply of 7,650-sheets (4,150 sheets standard plus a 3,500-sheet optional paper deck). Thus completing the full production circle - to provide an integral print-on-demand system for a broad range of applications.

Productive 105 ppm output (A4)

Automatic trayless duplexing

10 GB integrated Image Server

100 high capacity mailboxes

Compact and durable design

Easy and reliable operation

Large 7,650-sheet paper supply*

* with paper deck accessory

Professional finishing options





Specifications iR 105

MAIN UNIT	
Imaging System	Laser Dry Electrostatic Transfer
Developing System	Dry monocomponent toner projection
Fixing System	Heat Roller
Print Speed	105 ppm (A4) 50 ppm (A3)
Resolution	600 x 600 dpi Copy: 1200 x 600 dpi Print: 2400 x 600 dpi interpolated
Halftones	256 Graduations of Gray
Image Server Memory	10GB (HDD)
Warm-up Time	6 mins or less
Duplex	Standard Automatic Trayless duplexing
PAPER SUPPLY AND CAPACITY	
Document Sizes	A5R - A3
Paper Weights	64 to 200 gsm (all paper sources)
Input Paper Capacity	
Top Drawer	1500 sheets x 2
Cassette	550 sheets x 2
Stack Bypass	50 sheets
Optional Paper Deck	3500 sheets (7,650 Total)
MAIN UNIT DIMENSIONS	
Height	1395 mm
Width	1035 mm
Depth	795 mm
Weight	approx. 280kg (407Kg incl. Finisher K3N)
Power Supply	220-240V / 50Hz
Power Consumption	Within 3.0kW

OPTIONAL ACCESSORIES	
PAPER DECK - N1	
Capacity	3 500 sheets (80gsm)
Paper Sizes	A4, B5
PAPER DECK - S1	
Capacity	3 500 sheets (80 gsm)
Paper Sizes	A3, A4, A4R, B4, B5
FINISHER - K1N	
Number of Trays	2
Tray Capacity	Upper : 1000 sheets (A4) Lower : 2000 sheets (A4)
Staple Positions	1 - Any corner 2 - side margin
Staple Capacity	100 sheets (A4) 50 sheets (A3)
SADDLE FINISHERS - K3N OR K4N	
Number of Trays	3
Tray Capacity	Upper: 1000 sheets (A4) Lower: 2000 sheets (A4)
Saddle Stitch tray:	30 sets
Staple Positions	1 - Any corner 2 - side margin
Saddle Stitch Paper Size	A3, A4R, B4
Saddle Staple Capacity	15 sheets (60 pages)
Hole Punch	K3N: 2 holes K4N: 4 holes
Folding	V folding standard
BOOKLET TRIMMER - A1*	
Paper Sizes	A3, A4R, B4
Paper Weights	64 - 200 gsm
Stacking Capacity	2000 sheets
STACKER - A1	
Stacking Method	2 tray descending (stacking / offset stacking)
Capacity	1500 sheets (A4) 750 sheets (A3) per tray
Paper Weight	64 - 200 gsm
PAPER FOLDING UNIT - C1*	
Fold Type	Z fold
Paper Size and Weight	A3 - B4; 64-80 gsm
DOCUMENT INSERTER - B1*	
Paper Sizes	A3, A4, A4R, B4, B5
Paper Weight	64 to 200 gsm

CONTROLLERS	
NETWORK MULTI-PDL PRINTER KIT - B5	
Processor	64 bit RISC Chip 75 MHz
Memory	192 MB up to 256 MB
Hard Drive	10.2 GB
PDL	PCL 5e, PCL 6, Postscript 3 emulation
Printing Support	PDF, TIFF, JPEG, AS400, SAP R3
Interface Connection	RJ-45 (10/100 Ethernet), IEEE 1284, Optional Token Ring Card
Protocols Supported	IPX/SPX, TCP/IP, SMB Apple Talk
Network OS	Windows 9x/ME/2000/XP/Server 2003/NT 4.0 Novell Netware v.3.2 or later Solaris 1.x / 2.x or later Apple System 7.5 or higher

NETWORK MULTI-PDL PRINTER KIT - M2	
Processor	Intel Pentium III 1GHz
Memory	128 MB up to 256 MB
Hard Drive	20 GB
PDL	PCL 5e, PCL 6 Adobe Postscript 3
Printing Support	PDF, TIFF, JPEG, AS400, SAP R3
Interface Connection	10/100 Ethernet, IEEE 1284, Optional Token Ring Card
Protocols Supported	IPX/SPX, TCP/IP, SMB Apple Talk
Network OS	Windows 98 (SE)/ME/2000/XP/Server 2003/NT 4.0 Novell Netware v. 4.2, 5.1, or 6 Mac OS 8.6 to 9.2, Mac OS X v.10.2.3 SunOS 4.1.3 or later Solaris 2.5.1 or later Linux (only RedHat)

* The document Insertion Unit-B1, the Paper Folding Unit-C1, and the Booklet Trimmer-A1 can only be used with the Saddle Finisher - K3N or K4N

™ All company and/or product names are trademarks and/or registered trademarks of their respective manufacturers in their markets and/or countries.
Canon reserves the right to change specifications without notice.

you can
Canon

Canon Inc
www.canon.com

Canon Europa NV
www.canon-europe.com

Canon Deutschland GmbH
Europark Fichtenhain A10
47807 Krefeld

