



Document Solutions

> PRINT > COPY > SCAN > FAX

ECOSYS M5521cdn
ECOSYS M5521cdw
ECOSYS M5526cdn
ECOSYS M5526cdw

COLOR MULTIFUNCTION
PRODUCT
FOR A4 FORMAT

STRENGTHEN DESKTOP POWER AND FLEXIBILITY



KYOCERA MyPanel



Mobile Print



- Speedy A4 copy/print speed up to 26/26 cpm Mono/Color*.
- Fast scanning speed up to 30/23 ipm Mono/Color.
- Convenient with a built-in one-path duplex scanning Document Processor*.
- User friendly 4.3 inch color touch screen panel*.
- Standard 512MB RAM to perform heavy duty tasks without additional memory.
- Support Apple AirPrint and Mopria certified.
- High print quality with 1,200 x 1,200 dpi printing resolution.

*For ECOSYS M5526cdn / M5526cdw



Born to be Extraordinary

KYOCERA Document Solutions is Extraordinary for

- Broad Range of Multifunction Devices and Printers
- Optimized Total Cost of Ownership (TCO)
- Reliable with Long Life Drum and Parts
- New and Advanced Technology

KYOCERA Document Solutions strives to be a company that contributes to the society and demonstrates “Customer First” principle by providing customers with maximum value to increase their satisfaction. By adhering to the mission of producing document management devices that take balance between “Economy” and “Ecology”, KYOCERA Document Solutions succeeds to develop document management devices with advanced technologies which help customers to optimize office productivity and efficiency at a low total cost of ownership and, at the same time, improving environmental performance.

Easy of Use

These A4 color multifunctionals are specifically designed for small and medium-sized work groups that deliver outstanding print quality of 1,200dpi. All common functionalities can be quickly and easily accessed to optimize document workflow. What’s more, top reliability, fast output time and support optional business applications can improve overall productivity.

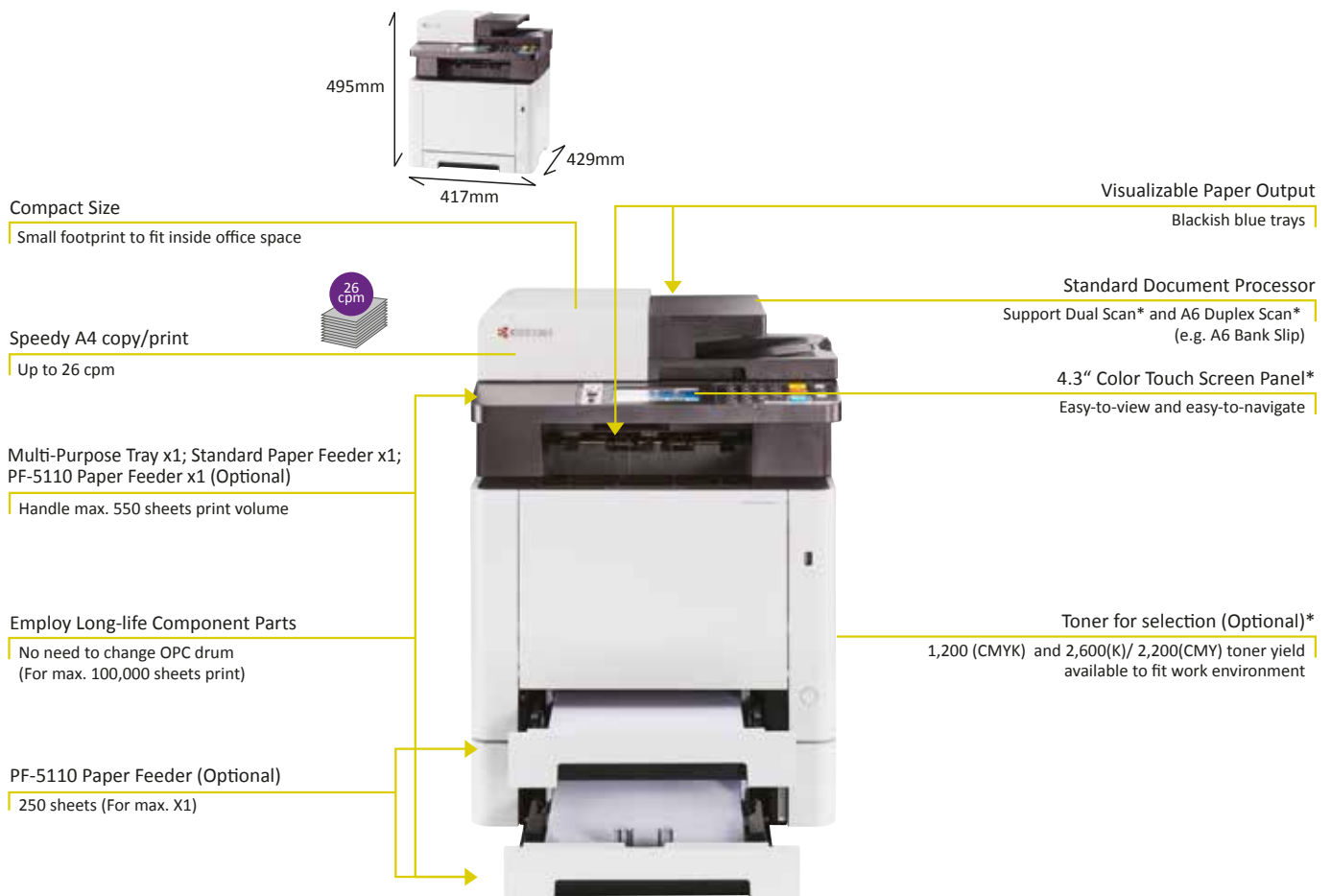

*For ECOSYS M5526cdn / M5526cdw
** For ECOSYS M5521cdn / M5521cdw

Superior Feature

COPY/PRINT

- Convenient Multi-Purpose Tray First Mode: Allow printing via Multi-Purpose Tray whenever paper is loaded there.
- Vivid Color quality by printing at 1,200dpi***.
- Direct print from USB memory.
- Save cost by using less paper.
Print: Allow 25-in-1
Copy: Allow 4-in-1
- 2-sided copy/print as standard.



SCAN

- Support mixed size A4/Letter and Legal original in Copy/Scan.
- Skip Blank Page Function: Automatically skip blank page in copy and scan.
- Fast scanning up to 30/23 ipm in A4 Mono/Color.
- Store scanned data easily by 'Scan to FTP', 'Scan to SMB', 'Scan to Email', 'Scan to USB', 'Scan to DFS'.

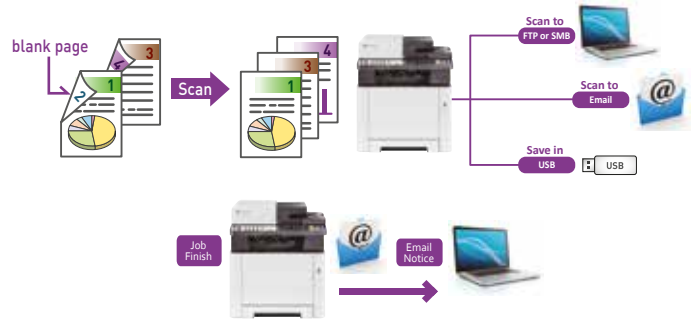

FAX

- A destination and other transmission settings can be registered as a favor to prevent sending to wrong recipient.
- Capable of sending and receiving fax via PC with network fax function.
- Fax broadcast up to 100 different destinations.



High Reliability and Security

- **Authentication management** among departments via IC Card.
- Sophisticated network security (**SSL, IPsec**) as standard and prevent improper access.
- **Private Print** enables secure print jobs with preset password request at the device (Require additional memory).



Save Environment

- Low energy consumption
Power consumption is low by using the new low melting toner.
Usage of white LED illumination for lower light emissions and power consumption.
- Free of Hazardous material
Fulfilled the requirements of **RoHS** (Restriction of Hazardous Substances) & usage of **Lead-Free Parts**.
- Reduce wastage by **Long Life Consumables and Drums**.
- Reduce noise by built-in **Quiet Mode*****.

Workflow Optimization with Business Applications

By combining the innovative Business Applications, these color MFPs can manage document in an effective approach.

- **KYOCERA MyPanel**
Remote control designated KYOCERA printing devices by smartphone or tablet.
- **KYOCERA Mobile Print**
Conveniently print files, web pages and images using smartphone or tablet.
- **KYOCERA Net Manager******
Control sensitive documents and reduce printing costs.
- **AirPrint**
Print documents, photographs, images, etc. directly from iOS devices/Mac.



***Print speed will be reduced.
****Optional

		Main Specifications			
Model		ECOSYS M5521cdn	ECOSYS M5521cdw	ECOSYS M5526cdn	ECOSYS M5526cdw
Main Function		Copy, Print, Scan, Fax			
Writing Method		Semiconductor Laser			
CPU		800MHz			
Print Speed (A4) (Mono/Color)		21/21 ppm		26/26 ppm	
Scanning Speed (A4) 300dpi (Mono/Color)		Simplex	30/23 ipm		30/23 ipm
		Duplex	----		12/8 ipm
Memory		Standard 512MB (Max. 1,536MB)			
Warm Up Time		32 seconds		29 seconds	
Paper Capacity		Standard	250 sheets (Cassette) + 50 sheets (MPT)		
		Maximum	550 sheets (Main Unit + 250 sheets PF-5110 + MPT)		
Paper Size		Cassette	Min. A6R – Max. A4 (Legal)		
		MPT	Min. A6R – Max. A4 (Legal)		
Paper Weight		Cassette	60 - 163 g/m ²		
		MPT	60 - 220 g/m ²		
Duplex Printing		Paper size: A5R - A4/Legal; Paper weight: 60 - 120 g/m ²			
Output Capacity		Max. 150 sheets face-down			
Control Panel		5 lines LCD		4.3 inch Color Touch LCD Panel	
Document Processor		Standard (Max. 50 sheets ADF Type)		Standard (Max. 50 sheets One-path duplex scanning Type)	
Dimension (W x D x H) (Main Unit)		417mm x 429mm x 495mm			
Weight (Main Unit)		Approx. 26kg			
Power Consumption (Standard configuration)		Copy/Print Mode	345W		375W
		Stand-by Mode	41W		
		Energy Saver	1W		
Noise (ISO7779/ ISO9296)		Copy/Print Mode	48dB(A); Quiet mode: 44dB(A)		49dB(A); Quiet mode: 44dB(A)
		Stand-by Mode	30dB(A)		
Copy Functions (Standard)					
Copy Size		Max. A4 (Legal) – Min. A6R			
Resolution		600 x 600 dpi			
First Copy Time (Mono/Color)		10/12 seconds		8/10 seconds	
Zoom Ratio		Manual	25% - 400% (1% per Step)		
		Pre-defined	7R5E		
Multiple Copy		1 – 999			
Print Functions (Standard)					
Resolution		600 x 600 dpi; 1,200 x 1,200 dpi			
PDL		PRESCRIBE, PCL6 (PCL-XL, PCL 5c), KPD3 (Postscript 3 compatible), XPS, PDF Direct Print Ver. 1.7			
First Print Out Time (Mono/Color)		11/12.5 seconds		9.5/10.5 seconds	
Supported Protocol		TCP/IP, NetBEUI, FTP, Port 9100, LPR, IPP, WSD Print, Apple Bonjour, IPsec, SNMPv3, IEEE802.1x, IPP over SSL/TLS, HTTP over SSL/TLS, FTP over SSL/TLS, SMTP over SSL/TLS, POP3 over SSL/TLS, Enhanced WSD over SSL/TLS			
Operating System Supported		Windows Server 2003, Windows Server 2008, Windows Server 2008 R2, Windows Server 2012, Windows Server 2012 R2, Windows XP, Windows Vista, Windows 7, Windows 8, Windows 8.1; Apple Macintosh OS X 10.5 or later; Linux			
Interface		USB 2.0 High Speedx1; Ethernet 10BASE-T/100BASE-TX/1000BASE-T; USB Host Interface (USB Host)x1, 802.11 b/g/n/Wireless LAN/WiFi Direct (ECOSYS M5521cdw/ ECOSYS M5526cdw only)			
USB Memory Printing		Standard			
USB Memory Printing Format		TIFF, JPEG, PDF, XPS			
Mobile Printing		AirPrint, Mopria, KYOCERA Mobile Print			
Scan Functions (Standard)					
Color Selection		Full Color; Grayscale; Black & White			
Resolution		600dpi, 400dpi, 300dpi, 200dpi, 200x400dpi, 200x100dpi			
File Format		TIFF, JPEG, XPS, OpenXPS, PDF (MMR/JPG compression/High-compression PDF), PDF/A, Encrypted PDF			
Image Type Mode		Text, Photo, Text + Photo, Light Text/Fine Line			
Transmission Type		Scan to SMB; Scan to E-mail; Scan to FTP or FTP over SSL; Scan to DFS; Scan to USB; TWAIN Scan; WSD Scan, WIA			
Address Storage		100 addresses (Common address list), 20 groups (Group address list)			
Fax Functions (Standard)					
Original Size		Max. A4 (Legal) – Min. A6			
Coding Method		MMR, MR, MH, JBIG			
Transmission Speed		33.6 kbps			
Memory		3.5MB			
One Touch Dial		22 numbers		100 numbers	
Network FAX		Yes			
Consumables & Options					
Toner Kit (Page Yield in accordance with ISO/IEC 19798)		TK-5234K : Black (2,600 pages)		TK-5244K : Black (4,000 pages)	
		TK-5234C/M/Y : Cyan/Magenta/Yellow (2,200 pages)		TK-5244C : Cyan (3,000 pages)	
		TK-5224K : Black (1,200 pages)		TK-5244M : Magenta (3,000 pages)	
		TK-5224C/M/Y : Cyan/Magenta/Yellow (1,200 pages)		TK-5244Y : Yellow (3,000 pages)	
Capacity of Start up Toner		Black 1,200 pages, Cyan/Magenta/Yellow 1,200 pages		Black 1,200 pages, Cyan/Magenta/Yellow 1,200 pages	
Paper Feeder		PF-5110: 250 sheets (Max. x1)			
Card Authentication		Card Authentication Kit(B)			



บริษัท เคียวเซรา ด็อกคิวเม้นท์ โซลูชันส์ (ประเทศไทย) จำกัด
 โทร. 0-2586-0333 โทรสาร 0-2586-0278
www.kyoceradocumentsolutions.co.th

KYOCERA Business Partner

*KYOCERA does not warrant that any specifications mentioned will be error-free. Specifications are subject to change without notice. Information is correct at time of going to press. All other brand and product names may be registered trademarks or trademarks of their respective holders and are hereby acknowledged.